

vtech[®]
Baby

User's Manual

Lights & Lullabies Travel Mobile™



© 2016 VTech
All rights reserved
Printed in China
91-003308-000 

Dear Parent,

Ever notice the look on your baby's face when they learn something new through their own discovery? These self-accomplished moments are a parent's greatest reward. To help fulfill them, VTech® created the **Infant Learning**® series of toys.

These unique interactive learning toys directly respond to what children do naturally – play! Using innovative technology, these toys react to baby's interactions, making each play experience fun and unique as they learn age-appropriate concepts like first words, numbers, shapes, colors and music. More importantly, VTech®'s **Infant Learning**® toys develop baby's mental and physical abilities by inspiring, engaging and teaching.

At VTech®, we know that a child has the ability to do great things. That's why all of our electronic learning products are uniquely designed to develop a child's mind and allow them to learn to the best of their ability. We thank you for trusting VTech® with the important job of helping your child learn and grow!

Sincerely,

Your friends at VTech®

To learn more about VTech® toys, visit vtechkids.com

INTRODUCTION

Thank you for purchasing the **VTech® Lights & Lullabies Travel Mobile™** learning toy!

The **Lights & Lullabies Travel Mobile™** by **VTech®** is the perfect mobile for babies on the go, featuring spinning stars, lights and soothing music. This compact mobile easily attaches to cribs, play yards, strollers and infant carriers.

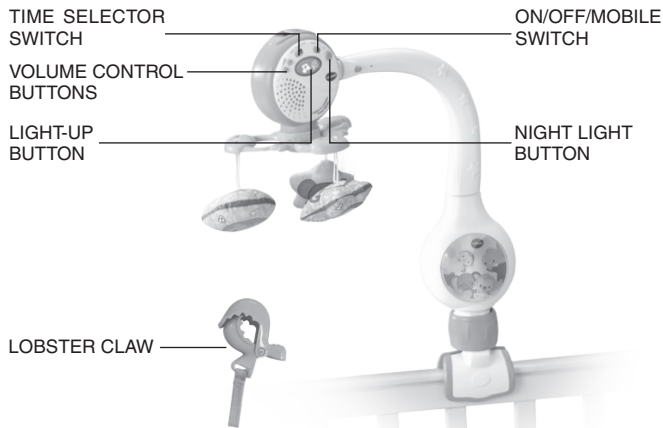

INCLUDED IN THIS PACKAGE

- One VTech® Lights & Lullabies Travel Mobile™ electronic module
- One mobile support post
- One mobile
- Three plush dangling stars
- One lobster claw with elastic strap with hook and loop closure
- One user's manual

WARNING: All packing materials, such as tape, plastic sheets, packaging locks and tags are not part of this toy, and should be discarded for your child's safety.

ATTENTION: Pour la sécurité de votre enfant, débarrassez vous de tous les produits d'emballage tels que rubans adhésifs, feuilles de plastique, attaches et étiquettes. Ils ne font pas partie du jouet.

Unlock the packaging locks:

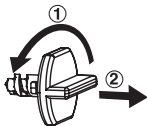

① Turn the packaging lock counter-clockwise several times.

② Pull out and discard the packaging lock.

GETTING STARTED

BATTERY INSTALLATION

1. Make sure the unit is turned OFF.
2. Locate the battery cover on the back of the electronic module. Use a screwdriver to loosen the screws.
3. Install 3 new 'AA' (AM-3/LR6) batteries following the diagram inside the battery box. (The use of new alkaline batteries are recommended for maximum performance.)
4. Replace the battery cover and tighten the screws to secure.

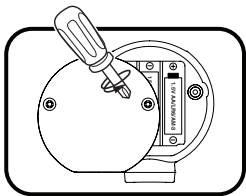

BATTERY NOTICE

- Install batteries correctly observing the polarity (+,-) signs to avoid leakage.
- Do not mix old and new batteries.
- Do not use batteries of different types.
- Remove batteries from the equipment when the unit will not be used for an extended period of time.
- Do not dispose of batteries in fire.
- Do not attempt to recharge ordinary batteries.
- The supply terminals are not to be short-circuited.
- Only batteries of the same and equivalent type as recommended are to be used.
- Do not mix alkaline, standard (carbon-zinc) or rechargeable (nickel-cadmium) batteries.

WE DO NOT RECOMMEND THE USE OF RECHARGEABLE BATTERIES.

DEMO TAG

The demo tag should be removed automatically when the product is taken out of the packaging. If the demo tag is still in position, please remove the plastic strip from the back of the product before placing in the crib. This will activate normal play.

With the **VTech® Lights & Lullabies Travel Mobile™**, safety comes first.

- Keep the mobile out of baby's reach. To avoid injuries, please remove the mobile from crib or play yard once baby begins sitting or pushing up on all fours.
- Age range of mobile - Birth to 5 months
- The crib mobile is intended for visual stimulation and is not intended to be grasped by a child.
- Always attach all provided fasteners (strings, straps, clamps, etc.) tightly to the crib according to the instructions. Check frequently. Attach only to cribs with sturdy rails and spindles.
- Do not add additional strings or straps to attach to a crib.
- To ensure your child's safety, the product should be assembled by an adult.
- NEVER use this product in a motor vehicle. Death or serious injury can occur from hard objects in the event of a motor vehicle accident.

To ensure your child's safety, the assembly of this product is an adult activity, not a child's activity. Please ensure that the crib attachment clamp is securely locked into position to avoid injury. Follow the instructions below carefully and make sure the final assembly is correct.

ASSEMBLY INSTRUCTIONS

1. Attach the three plush stars to the mobile. Thread the cord from one of the plush stars up through the hole in the bottom of one of the leaves, then thread it down through the hole on the opposite side. Secure the loop over the notch on the underside of the leaf. Pull gently on the star to make sure it is securely fastened. Follow the above instructions for the remaining stars.
2. Attach the mobile to the bottom of the electronic module. You will hear the mobile click into place when inserted correctly.
3. Attach the mobile support post to cribs and play yards with rails that are between .40 inches and 1.57 inches wide. Twist the blue sleeve to tighten the clamp to the crib rail or play yard. Pull slightly on the support post to make sure the clamp has been securely fastened. Please check the support post frequently to ensure it is still secure.

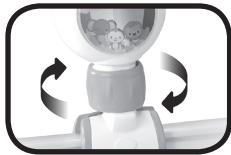
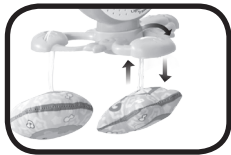

4. Attach the electronic module to the support post by pressing the small blue button on the support post while sliding the electronic module onto the support post . Check to make sure the electronic module is attached securely to avoid injuries.



5. To use the mobile as a travel mobile, remove the electronic module from the mobile support post by pulling gently on the electronic module while pressing the blue button on the support post.



6. Thread the elastic hook and loop closure through the slot on the top of the electronic module, securing the hook and loop fabric together.

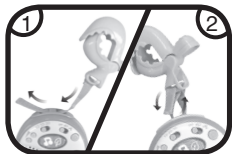

7. Use the elastic loop or the lobster claw to attach the mobile to infant carriers and strollers. Always check to make sure the mobile is attached securely to avoid injuries.



PRODUCT FEATURES

1. ON/OFF/MOBILE SWITCH

To turn the unit **ON**, slide the **ON/OFF MOBILE SWITCH** to the **TURNING MODE** (🎵) or the **STATIONARY MODE** (🏠) position. To turn the unit **OFF**, slide the **ON/OFF/MOBILE SWITCH** to the **OFF (OFF)** position.

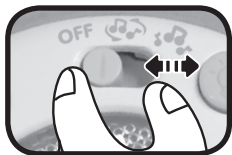

2. TIME SELECTOR SWITCH

Slide the **TIME SELECTOR SWITCH** to the 10/20/30 minute position.



3. VOLUME CONTROL BUTTONS

To adjust the volume, press the **VOLUME +** and **VOLUME -** buttons.



4. NIGHT LIGHT BUTTON

Press the **NIGHT LIGHT BUTTON** to turn the night light on or off. This feature only works when the mobile is connected to the mobile support post.



5. SOUND SENSOR

The **VTech® Lights & Lullabies Travel Mobile™** is equipped with a special sound sensor. To preserve battery life, the sound sensor will only function when the mobile is connected to the mobile support post. Once the selected time setting has ended, the unit will automatically power-down. The sensor will reactivate the program when it detects baby's cry for approximately several seconds without interruption.

6. AUTOMATIC SHUT-OFF

To preserve battery life, the **VTech® Lights & Lullabies Travel Mobile™** will automatically power-down after the selected time has ended. The unit can be turned on again by pressing any button.

Note: If the unit repeatedly powers down quickly or the light-up press button fades out, we suggest changing the batteries.

ACTIVITIES

1. Slide the **on/off/mobile switch** to turn the unit on. You will hear a soothing phrase followed by soothing music. The light-up button will fade in and out with the sound when the electronic module is removed from the mobile support post.
2. Press the **light-up button** to change to the next song or melody. Hold down the **light-up button** to hear a short tune. The light-up button will fade in and out with the sound when the electronic module is removed from the mobile support post.

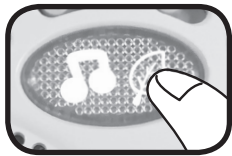
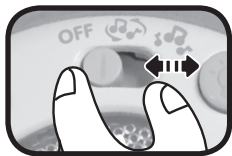

MELODY LIST:

1. A-Tisket, A-Tasket
2. All Through the Night
3. Are You Sleeping?
4. Baa Baa Black Sheep
5. Cradle Song - Mozart
6. Hot Cross Buns
7. Humpty Dumpty
8. Hush Little Baby
9. Rock-a-bye Baby
10. Jack and Jill
11. Little Bo Peep
12. Little Miss Muffet
13. London Bridge
14. Muffin Man
15. Here We Go Round the Mulberry Bush
16. Polly Put the Kettle On
17. Pussy Cat, Pussy Cat
18. Ring Around the Rosy
19. Row, Row, Row Your Boat
20. Simple Simon
21. Sing a Song of Sixpence
22. Swing Low, Sweet Chariot
23. Twinkle, Twinkle, Little Star
24. One Man Went to Mow a Meadow
25. Bicycle Built for Two
26. Cradle Song - Weber
27. Glow Worm
28. Diddle, Diddle Dumpling
29. White Coral Bells
30. Hey Diddle Diddle
31. Mary, Mary Quite Contrary
32. Aiken Drum
33. My Bonnie Lies Over the Ocean
34. To Market, To Market

- 35. Three Blind Mice
- 36. Clementine
- 37. Cockles & Mussels
- 38. Goodnight Ladies
- 39. Alouette
- 40. Beautiful Dreamer

SUNG SONG LYRICS

SONG 1

Hush, little baby, don't say a word.
Papa's gonna buy you a mockingbird.
And if that mockingbird won't sing,
Papa's gonna buy you a diamond ring.

SONG 2

Sleep, my child, and peace attend thee,
All through the night.
Guardian angels I will send thee,
All through the night.

SONG 3

Ring around the rosy,
A pocket full of posies,
Hush-a, hush-a,
We all fall down.

CARE & MAINTENANCE

1. Keep the unit clean by wiping it with a slightly damp cloth.
2. Keep the unit out of direct sunlight and away from any direct heat source.
3. Remove the batteries when the unit will not be in use for an extended period of time.
4. Do not drop the unit on hard surfaces and do not expose the unit to moisture or water.

TROUBLESHOOTING

If for some reason the program/activity stops working, please follow these steps:

1. Please turn the unit **OFF**.
2. Interrupt the power supply by removing the batteries.
3. Let the unit stand for a few minutes, then replace the batteries.
4. Turn the unit **ON**. The unit should now be ready to play again.
5. If the product still does not work, replace with a new set of batteries.

If the problem persists, please call our Consumer Services Department at 1-800-521-2010 in the U.S. or 1-877-352-8697 in Canada, or by going to our web site at www.vtechkids.com and filling out our Contact Us form located under the Customer Support link. A service representative will be happy to help you.

IMPORTANT NOTE:

Creating and developing VTech® products is accompanied by a responsibility that we at VTech® take very seriously. We make every effort to ensure the accuracy of the information, which forms the value of our products. However, errors sometimes can occur. It is important for you to know that we stand behind our products and encourage you to call our Consumer Services Department at 1-800-521-2010 in the U.S. or 1-877-352-8697 in Canada, or by going to our web site at www.vtechkids.com and filling out our Contact Us form located under the Customer Support link with any problems and/or suggestions that you might have. A service representative will be happy to help you.

Adult assembly required

**Ce jouet doit être assemblé
par un adulte.**

FCC Notice:

This equipment has been tested and found to comply with the limits for a Class B digital device, pursuant to Part 15 of the FCC Rules. These limits are designed to provide reasonable protection against harmful interference in a residential installation. This equipment generates, uses and can radiate radio frequency energy and, if not installed and used in accordance with the instructions, may cause harmful interference to radio communications. However, there is no guarantee that interference will not occur in a particular installation. If this equipment does cause harmful interference to radio or television reception, which can be determined by turning the equipment off and on, the user is encouraged to try to correct the interference by one or more of the following measures:

- Reorient or relocate the receiving antenna
- Increase the separation between the equipment and receiver
- Connect the equipment into an outlet on a circuit different from that to which the receiver is connected
- Consult the dealer or an experienced radio/TV technician for help

Caution: Changes or modifications not expressly approved by the party responsible for compliance could void the user's authority to operate the equipment.

THIS DEVICE COMPLIES WITH PART 15 OF THE FCC RULES. OPERATION IS SUBJECT TO THE FOLLOWING TWO CONDITIONS: (1) THIS DEVICE MAY NOT CAUSE HARMFUL INTERFERENCE, AND (2) THIS DEVICE MUST ACCEPT ANY INTERFERENCE RECEIVED, INCLUDING INTERFERENCE THAT MAY CAUSE UNDESIRE OPERATION.

CAN ICES-3 (B)/NMB-3(B)



PRODUCT WARRANTY

This Warranty is applicable only to the original purchaser, is non-transferable and applies only to "VTech" products or parts. This product is covered by a 3-month Warranty from the original purchase date, under normal use and service, against defective workmanship and materials. This Warranty does not apply to (a) consumable parts, such as batteries; (b) cosmetic damage, including but not limited to scratches and dents; (c) damage caused by use with non-VTech products; (d) damage caused by accident, misuse, unreasonable use, immersion in water, neglect, abuse, battery leakage, or improper installation, improper service, or other external causes; (e) damage caused by operating the product outside the permitted or intended uses described by VTech in the owner's manual; (f) a product or part that has been modified (g) defects caused by normal wear and tear or otherwise due to the normal aging of the product; or (h) if any VTech serial number has been removed or defaced.

Prior to returning a product for any reason, please notify the VTech Consumer Services Department, by sending an email to vtechkids@vtechkids.com or calling 1-800-521-2010. If the service representative is unable to resolve the issue, you will be provided instructions on how to return the product and have it replaced under Warranty. Return of the product under Warranty must adhere to the following rules:

If VTech believes that there may be a defect in the materials or workmanship of the product and can confirm the purchase date and location of the product, we will at our discretion replace the product with a new unit or product of comparable value. A replacement product or parts assumes the remaining Warranty of the original product or 30 days from the date of replacement, whichever provides longer coverage.

THIS WARRANTY AND THE REMEDIES SET FORTH ABOVE ARE EXCLUSIVE AND IN LIEU OF ALL OTHER WARRANTIES, REMEDIES AND CONDITIONS, WHETHER ORAL, WRITTEN, STATUTORY, EXPRESS OR IMPLIED. IF VTECH CANNOT LAWFULLY DISCLAIM STATUTORY OR IMPLIED WARRANTIES THEN TO THE EXTENT PERMITTED BY LAW, ALL SUCH WARRANTIES SHALL BE LIMITED TO THE DURATION OF THE EXPRESS WARRANTY AND TO THE REPLACEMENT SERVICE AS DETERMINED BY VTECH IN ITS SOLE DISCRETION.

To the extent permitted by law, VTech will not be responsible for direct, special, incidental or consequential damages resulting from any breach of Warranty.

This Warranty is not intended to persons or entities outside the United States of America. Any disputes resulting from this Warranty shall be subject to the final and conclusive determination of VTech.